

ATTENTION:

OBSERVE PRECAUTIONS FOR HANDLING ELECTROSTATIC DEVICES

Removal/Installation of Major Assemblies - Merit Boardwalk

Hard Drive Removal

1. If you are connected to TournaMAXX or TournaCHAMP, you must perform an **Update From Server** before removing the hard drive so that no information is deleted.
2. Turn off and unplug the game.
3. Loosen the 2 screws on the underside of the control panel, then unlock and open the panel.
4. Remove the 2 screws holding the liquid catch pan in place on the electronics box and disconnect the catch pan's fan connection. Pull gently on the catch pan until it unsnaps at the drainage hole and can be removed.
5. Loosen the screw on the hard drive support bracket and disconnect the hard drive ribbon cable. See Figure 1.
6. Remove the screw supporting the hard drive mounting plate and slide the hard drive and mounting plate off of the electronics box cover. See Figure 1.
7. Remove the 4 screws and washers from the hard drive mounting plate, then carefully extract the hard drive. See Figure 1.

Hard Drive Installation

1. Insert the new hard drive, circuit board-side down with the connection facing left, into the hard drive mounting plate. Secure the hard drive in place with 4 screws and washers. See Figure 1.
2. Slide the hard drive mounting plate into place on the electronics box cover and secure it with the existing screw. See Figure 1.
3. Connect the hard drive ribbon cable to the hard drive. Note that 4 pins on the hard drive are set off and will remain unconnected. Make certain that the red stripe on the ribbon cable (indicating pin-1 position) is inserted facing the unconnected pins. See Figure 3.
4. Secure the ribbon cable in place with the hard drive support bracket and tighten the screw. See Figure 1.
5. Place the liquid catch pan over the electronics box and snap into place at the drainage hole. Secure the catch pan in place with the 2 existing screws.
6. Reconnect the catch pan's fan connection.
7. Close and lock the control panel. Tighten the screws on the underside of the panel.
8. Plug in and turn on the game.

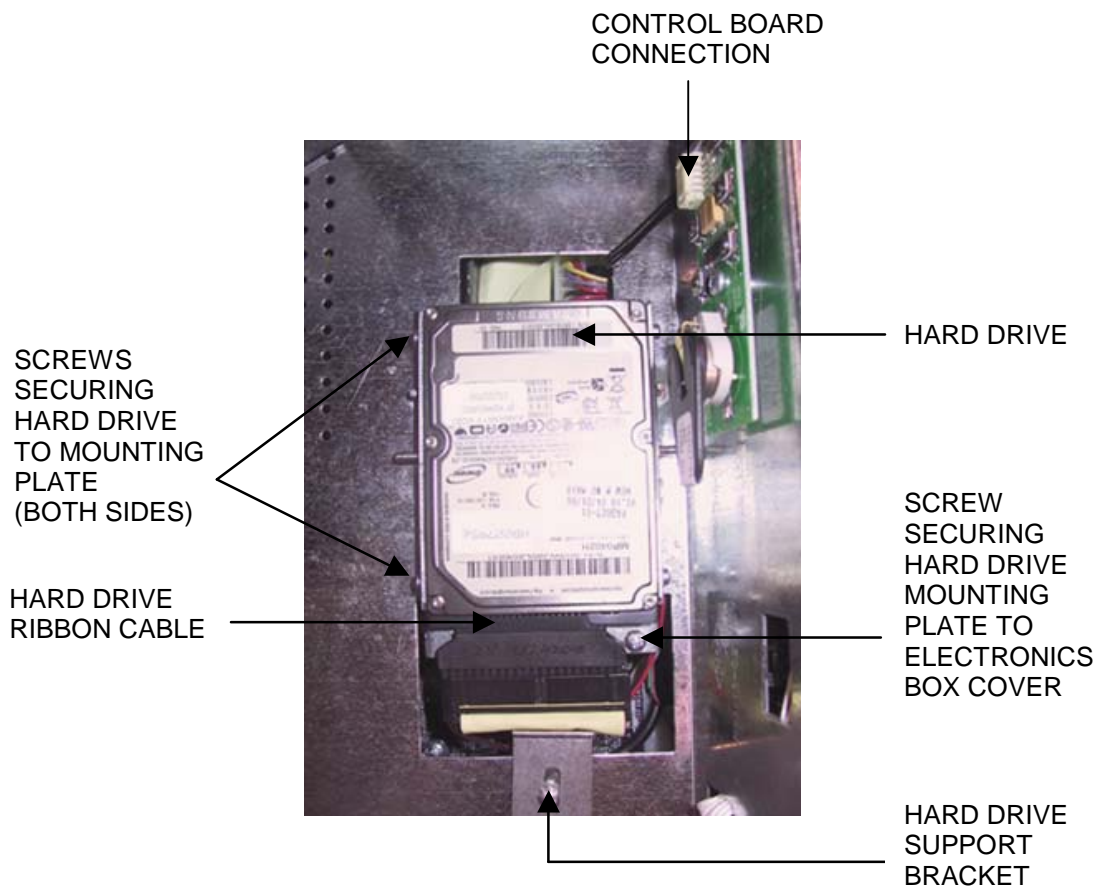

FIGURE 1 - SCREWS SECURING MOTHERBOARD

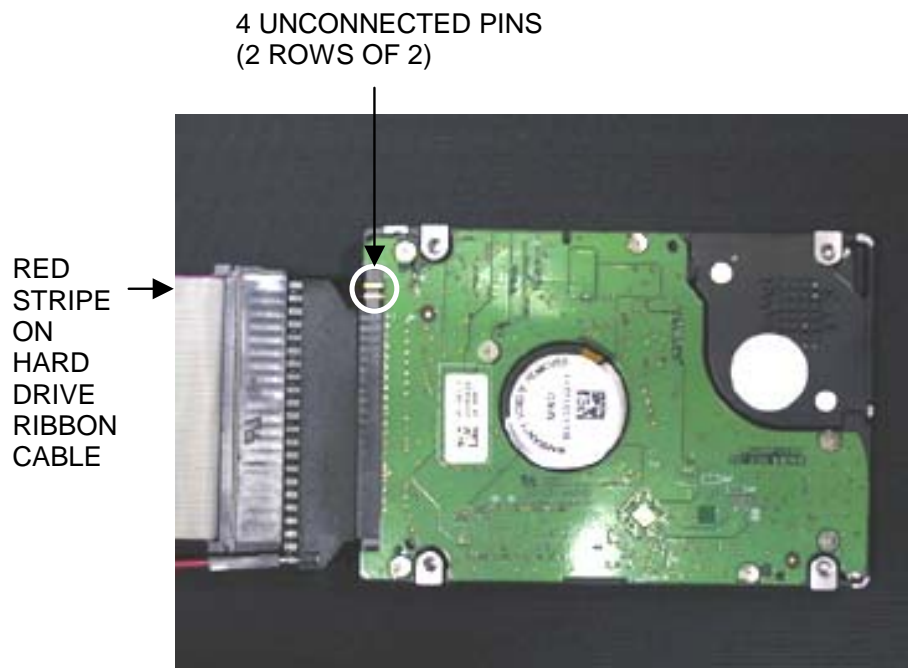

FIGURE 2 - CIRCUIT-BOARD SIDE OF HARD DRIVE

Troubleshooting Information - Removal/Installation of Major Assemblies - Merit Boardwalk